

PZ26-12000001  
05/20/2026  
304 East Atlantic Blvd.  
Pompano Beach, FL 33060  
PH: (954) 788-3400

Florida Engineering Business License: CA7928  
Florida Surveyor and Mapper Business License: LB6860  
Florida Landscape Architecture Business License: LC2600045

[illegible]

**PRELIMINARY PLAN**  
**NOT FOR CONSTRUCTION**

THESE PLANS ARE NOT FULLY PERMITTED  
AND ARE SUBJECT TO REVISIONS MADE  
DURING THE PERMITTING PROCESS.

**RESPONSIBILITY FOR THE USE OF THESE  
PLANS PRIOR TO OBTAINING PERMITS FROM  
ALL AGENCIES HAVING JURISDICTION OVER  
THE PROJECT WILL FALL SOLELY UPON THE  
USER.**

ISSUE DATE:	02/25/2026
-------------	------------

DESIGNED BY: SL, KU

DRAWN BY: KU, EZ

**BID-CONTRACT:**

PAUL H. WEINBERG, PLA  
FLORIDA REG. NO. LA6666804  
(FOR THE FIRM)

## CLIENT

**RP  
POMPA  
LLC**

PROJECT

## DOWNTOWN POMPANO

**SHEET TITLE**

## PHOTOMETRIC PLAN

**SHEET  
NUMBER** **LL-108**

PROJECT NUMBER	15083.00
-------------------	----------

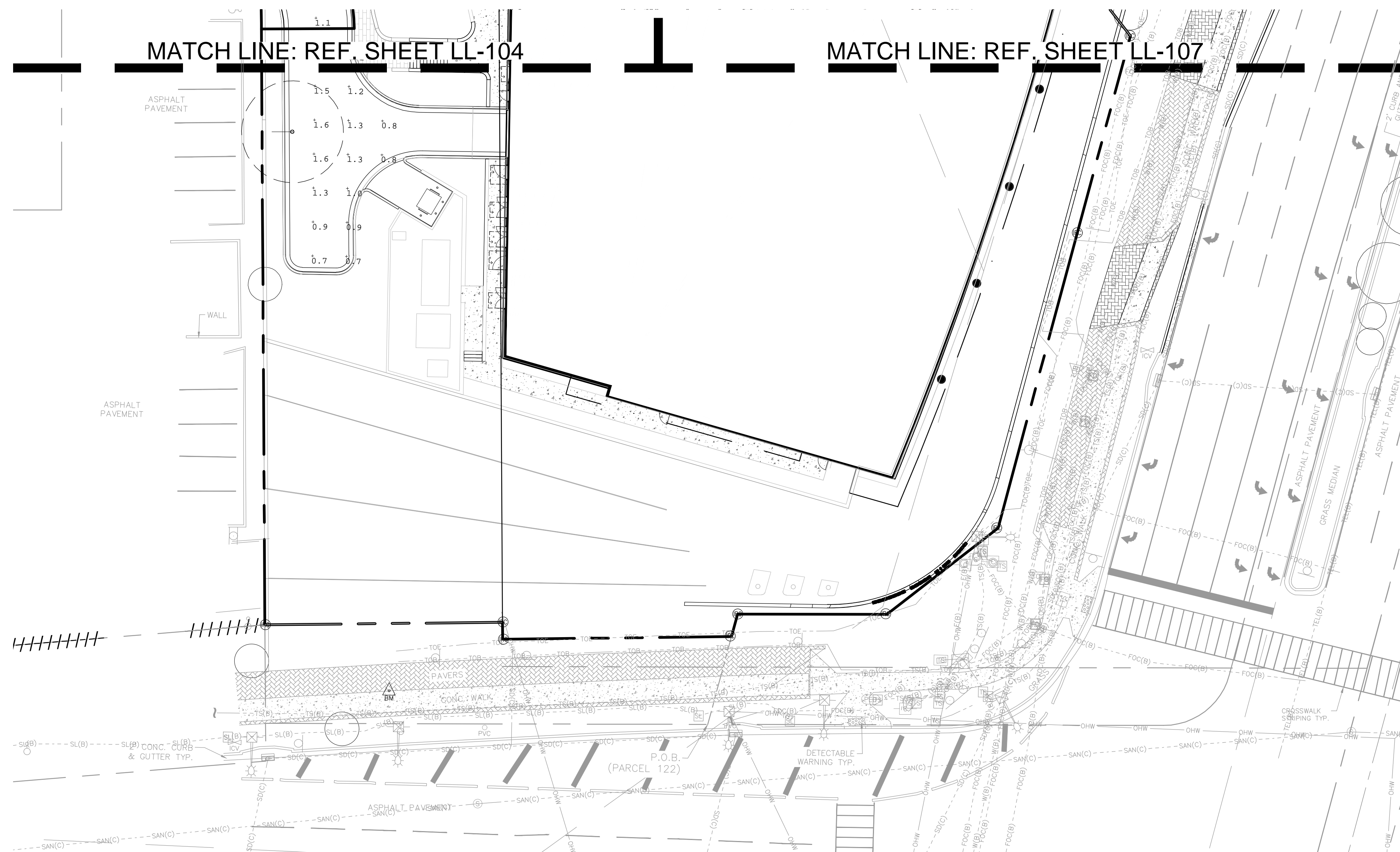
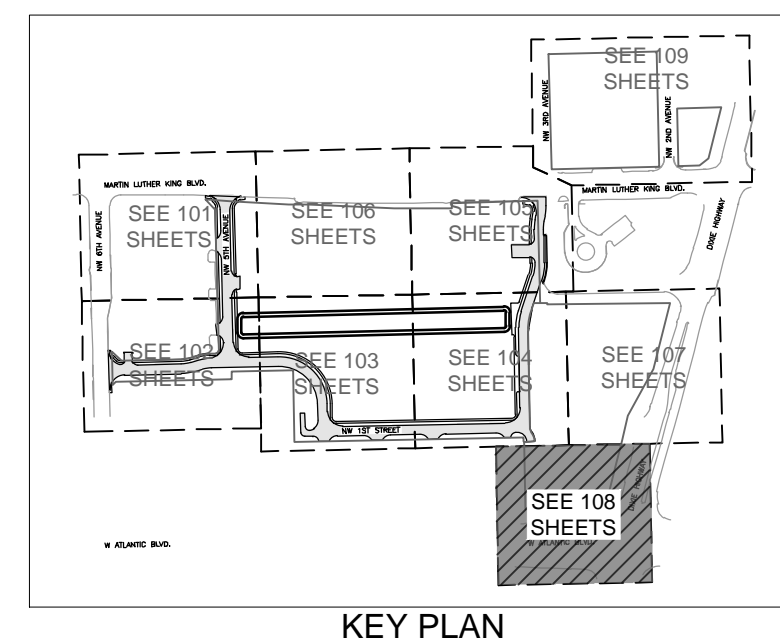

Luminaire Schedule								
Symbol	Qty	Label	Arrangement	Lum. Lumens	LLD	Luminaire Watts	Total Watts	Description
	24	L1	Single	6172	1.000	54.4	1305.6	LUME/C SIKU-SW52LED-4K-GR3-ACRD-LE2R-UNV-DMG (POLE MTD 30' F 0")

Calculation Summary								
Label	Calc Type	Units	Avg	Max	Min	Avg/Min	Max/Min	Grid Z
ROADWAY	Illuminance	Fc	1.09	2.1	0.5	2.18	4.20	0

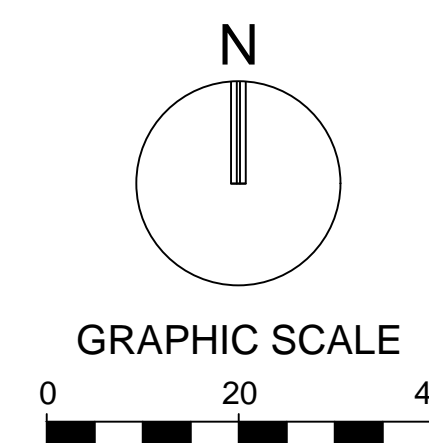

SCALE: 1" = 20'

NOTE: PRINTED DRAWING SIZE  
MAY HAVE CHANGED FROM  
ORIGINAL. VERIFY SCALE USING  
BAR SCALE ABOVE.

Plotted by: rkinsey On 2/25/2026 2:27 PM

Drawing name: H:\15083.00 - DOWNTOWN POMPADOUR - RP Development\LLC\Landscpe Architecture\CAD\15083.00-LL-1-XX.dwg

STATISTICS: DPEI IMINAPV